

# SECURITHERM BIOCLIP

## thermostatic basin mixer

Ref. H9605610

Single hole sequential thermostatic mixer H. 95mm L. 120mm

2026 UK public price excluding VAT: £476.60

### DESCRIPTION

SECURITHERM BIOCLIP thermostatic basin mixer - Ref. H9605610

Deck-mounted SECURITHERM thermostatic basin mixer.  
Sequential thermostatic mixer: opens and closes with cold water.  
No risk of cross flow between the hot and cold water.  
No non-return valves on the inlets.  
BIOCLIP: mixer can be easily removed for cleaning and disinfection.  
Anti-scalding failsafe: shuts off automatically if cold or hot water supply fails.  
Securitouch thermal insulation prevents burns.  
Single hole mixer with curved spout, H. 95mm L. 120mm, fitted with a hygienic flow straightener, no build-up of impurities and withstands thermal shocks.  
Scale-resistant sequential thermostatic cartridge for single control adjustment of flow rate and temperature.  
Temperature adjusts from cold water up to 40°C with maximum temperature limiter set at 40°C.  
Tested without water to comply with NHS requirements. No pre-set temperature.  
Thermal and chemical shocks are possible.  
Spout and body with smooth interior and low water volume.  
Flow rate limited to 5 lpm at 3 bar.  
No manual contact thanks to Hygiene control lever L. 146mm.  
Without pop-up waste.  
Supplied with copper tails and chrome-plated brass stopcocks.  
Fixing reinforced via 2 stainless steel rods.  
Ideal for healthcare facilities, retirement and care homes, hospitals and clinics.  
Mixer suitable for people with reduced mobility.  
Mixer with 30-year warranty.  
Also available with PEX flexibles.





### TECHNICAL CHARACTERISTICS

SECURITHERM BIOCLIP thermostatic basin mixer - Ref. H9605610

Connector	M1/2", Ø 15mm
Technology	SECURITHERM BIOCLIP sequential thermostatic mixer
Drop height	95mm
Spout length	120mm
Flow rate	5 lpm at 3 bar
Temperature limiter	Yes
Finish	Chrome-plated brass



### ADVANTAGES

-  Maximum hygiene: mixer has no non-return valves
-  Hygiene: can be removed for internal cleaning
-  SECURITHERM: anti-scalding safety
-  Sequential: opens/closes with cold water

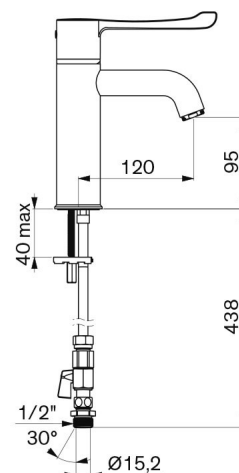

Norms



Warranty



Repairability

